

JUNE 2017



Citizen bird surveyors have been watching this barred owl and her chick in Lincoln Park. Photo courtesy Kersti Muul

## LINCOLN PARK MONITORS JOIN AUDUBON BIRDING PROJECT

This spring, Lincoln Park was center stage in the start of a citywide effort to reduce hazards for migratory birds using the Pacific flyway.

In early May, city and the U.S. Fish and Wildlife Service officials came to the park to sign the Urban Bird Treaty. Backed by Seattle Audubon and approved by the city council, the treaty enlists a partnership of advocates to develop hazard-reduction programs, restore habitat, and connect residents of all ages to avian nature in the city.

A few months earlier, Lincoln Park joined the Neighborhood Birding Project started by Seattle Audubon in 1995. Lincoln is the first addition in over a decade.

The project uses citizen science to monitor bird species throughout the city. Watchers muster at 8 am on second Sundays and work for about an hour and a half to survey north and south halves of the park.

Findings are entered into a citywide database that, over time, will be used to track bird abundance and diversity, assess the effectiveness of habitat restoration, and educate both volunteers and the general public.

Volunteer Kersti Muul is leading the surveys as Audubon's "ambassador" for Lincoln Park. To learn more and to enroll as a surveyor, contact Kersti at 360-317-4646 or [kerstimuul@rocketmail.com](mailto:kerstimuul@rocketmail.com).

### IN THIS ISSUE

Schoolhouse centennial celebration .....	3
Ferry terminal "quick wins" .....	5
Upcoming events .....	6
From the president.....	8

## NEW KENNEY LEADER COMMITS TO COMMUNICATION, FORWARD MOTION

By Judy Pickens

When René Dumas came to The Kenney in February as executive director, he concentrated on getting acquainted with staff, residents, and operations. Now he's turned much of his attention to steering the 108-year-old continuing-care community into a place baby boomers will want to call home.

Nine years ago, The Kenney announced plans for a major expansion, only to shelve them because of the recession and enter a period of interim management. Three years later, The Kenney regained financial traction and new management by affiliating with East Coast-based Heritage Ministries.

Last fall, The Kenney announced its intention to add housing, enlarge units, and update services. Then after only two years at the helm, the executive director retired.

To regroup, Heritage Ministries brought in René, whose career in senior living dates from 1984. Assignments in Washington and Oregon most recently included being executive director at Skyline and Park Shore, both affiliates of Transforming Age (formerly Presbyterian Retirement Communities of the Northwest).

While acknowledging that leadership changes and plans that didn't materialize have harmed perceptions, René says The Kenney is now positioned to move forward. A new facilities director, whom he

*(continued p. 7)*

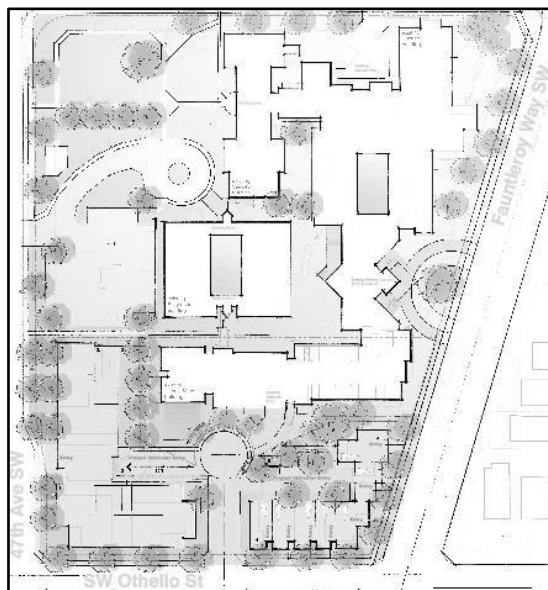

Early conceptual drawing of Kenney expansion south to SW Othello to add townhouses and apartments. Courtesy Shoemsmith Cox Architects

# MURRAY CSO FACILITY AT LOWMAN BEACH TO OPEN JUNE 10

King County is planning a free community celebration on **Saturday, June 10, 10 am - noon**, to mark completion of the Murray CSO "wet weather facility" across from

Lowman Beach Park. Cross streets are Lincoln Park Way SW and Beach Drive.

Started in 2011 and budgeted at \$56.5 million, the project built the facility and updated the pump station to reduce the likelihood of combined-sewer overflows into Puget Sound during major rain storms. Historically, an average of five storms per year overwhelmed the original pump station, sending some 5 million gallons of sewage and stormwater annually into marine habitat.

The new facility will collect up to a million gallons of sewage and polluted stormwater in an underground storage tank during heavy rains, then send it on to the West Point Treatment Plant after the storm has passed.

The event will enable area residents to learn how the facility will protect water quality and public health and offer feedback on the design and construction process. Those nine years of age and older may also take a tour inside.

To ask a question or request special accommodations at the celebration, email [kelly.foley@kingcounty.gov](mailto:kelly.foley@kingcounty.gov) or call 206-477-8621.



The public staircase links visitors to the viewpoint on the stormwater storage tank's green roof with Lowman Beach Park. Photo courtesy King County

## FCA LEADERSHIP

Mike Dey, president  
206-661-0673; [msdey50@aol.com](mailto:msdey50@aol.com)

Richard Hansen, vice president

Alexis Zolner, treasurer  
206-935-6721; [aazathome@outlook.com](mailto:aazathome@outlook.com)

Frank Immel, secretary

Shannon Ninburg, secretary of record

Gary Dawson, chairman, Ferry Advisory Committee  
206-937-7163; [garyann@quidnunc.net](mailto:garyann@quidnunc.net)

Vicki Schmitz-Block      Bruce Butterfield

Kathleen Dellplain      David Haggerty

Susan Lantz-Dey      Jewel Von Kempf

Martin Westerman

Irene Stewart, webmaster/Facebook  
[FCAcommunications@gmail.com](mailto:FCAcommunications@gmail.com)

Judy Pickens, writer/editor, [judy\\_pickens@msn.com](mailto:judy_pickens@msn.com)



## COLOR BRIGHTENS TRIANGLE

Thanks to Sandy and Terry Henderson and Alexis Zolner for planting more than 500 tulip bulbs in the new Fautleroy triangle planter boxes. The brightly colored flowers were a welcome sight this spring against the black planters and perennials.

Also volunteering to water and tidy the planters: Marianne Crocker, Paula Lindsay, Darlene Allen, Gretchen Van Dyk, Jo Hanson, Teresa Squillace, and Ken Katayama. Tim Pavolka and Mike Carr, owners of the office building, are supplying the water. The city plans to add planters in front of other businesses and FCA will maintain those as well.

## WEST SEATTLE BLOG

West Seattle news, 24/7

[westseattleblog.com](http://westseattleblog.com)

Breaking news? Text or call 206-293-6302.



# FAUNTLEROY SCHOOLHOUSE CENTENNIAL CELEBRATION

MAY 21, 2017

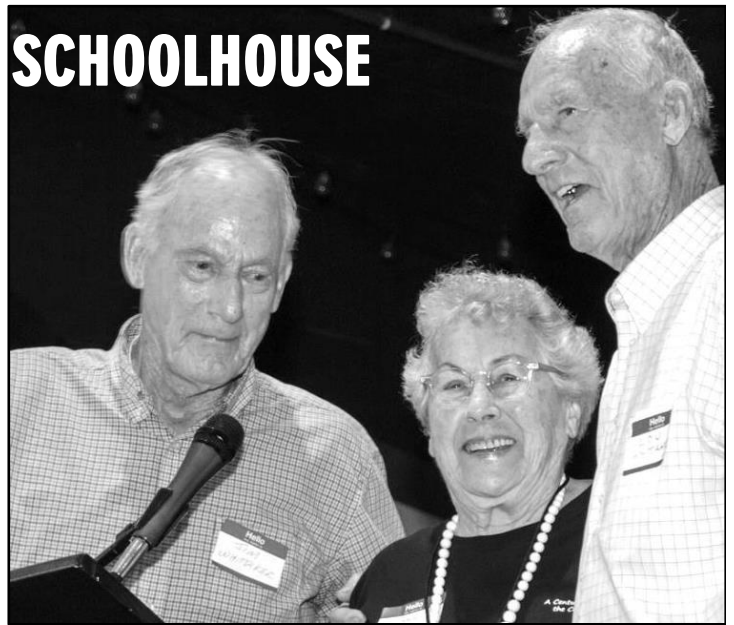

Jim and Lou Whittaker were featured alumni speakers, introduced by Jane Hastings.

As on school days, the event began with the hoisting of the flag on the new pole donated by the Gamrath family.

**ABOUT THE FAMILY:** David Olaf Nielsen Gamrath came to Seattle from Denmark in 1911 and later married fellow Dane Kristine Anderson. Their two children, Margaret and John, attended the new Fauntleroy School, starting in 1918.

Several years later, David's nephew, Bob, left his family's farm in Montana to join the household at 36th Ave. SW and SW Henderson and the three cousins' lives were intertwined from then on. Bob's four children - Sandy, Christy, Tom, and Dave - kept Gamraths on the Fauntleroy School roster from 1953 to 1971. All still live in the area.



FCA supported the celebration by funding refreshments and schoolhouse neighbors and friends donated in myriad other ways. FCA boardmembers Marty Westerman, Kathleen Dellplain, and Bruce Butterfield were among helpers in the kitchen.



Hundreds of people attended the celebration and Jack Pierce greeted many of them. He was a major force behind the Fauntleroy Community Service Agency, which saved the schoolhouse as a community center in 2010.



Planners thought of everything, including school-lunch milk.

Photos generously contributed by Gail Ann Photography

## BROUGHT TO YOU BY

Members of the schoolhouse centennial committee were Frances Gifford, Kim Sheridan, Jane and Laurie Hastings, Bonnie Beerman, Nancy McPhee, Clay Eals, Laura Tyler, Brad Chrisman, Frank Cunningham, Susan Lantz-Dey, David Haggerty, Cindi Marshall, April Carson, Christy Gamrath, Chris Bath, Carol Karlstrom, and Sue Madill.



Extensive displays included many class photos popular with students' older selves.

## DINE-OUT A WIN FOR FESTIVAL



Dani the pig at Endolyne Joe's front door was duded up for the restaurant's all-day fund-raiser May 3 to benefit the Fauntleroy Fall Festival. Joe's donation of a percent of sales, plus entries to win a generous number of raffle baskets, brought in \$2,333.23. The steering committee is already working toward the Oct. 15 festival. Photo courtesy Judy Pickens

## FCA'S BUSINESS & ORGANIZATION PARTNERS

Brace Point Law  
 Bruce Butterfield, Berkshire Hathaway Real Estate  
 Cherie's Canine Casa  
 Dance! West Seattle  
 Daystar Retirement Village  
 Devir Americas, LLC  
 DSquared: Occasions With Soul  
 Endolyne Joe's Restaurant  
 Fauntleroy Church, United Church of Christ  
 Fauntleroy Community Service Agency  
 Innate Vitality Wellness Studio  
 Ocean Light Zen Center  
 Pilates At Fauntleroy  
 Sheppard Bookkeeping Services  
 South Tacoma Way, LLC  
 Stuffed Cakes  
 Synergy HomeCare  
 The Kenney Retirement Community  
 West Seattle and Fauntleroy YMCA  
 West Seattle Blog  
 Wildwood Market

## Let Us Help You At Home

Senior Care • Respite Care • Alzheimer's • Dementia  
 Surgery Recovery • Pregnancy/New Moms  
 Hourly/Daily/Weekly • No Contracts or Min. Hours



**FREE In-Home Assessment**  
**206-420-4934**  
**SynergyHomeCare.Com**

## CITY WEIGHING FUTURE OF SEAWALL

The future of the seawall at Lowman Beach Park is in full play after a May 31 open house to acquaint residents and park users with coastal processes and action options.

The original seawall, built by the Works Progress Administration during the Depression era, failed and was replaced in the early 1950s by a 250 ft. wall. It began failing in the mid 1990s and the city removed the south half. By late 2015, the remaining 130-ft. section of the wall was cracked and tilting, so Seattle Parks and Recreation initiated a feasibility study to understand options, including what the ramifications of restoring a natural beach might be.

According to project lead David Graves, the study looked at what effect removal might have on seawalls to the north and if a better solution might be to build a new wall. It included a public survey to document how much the public uses the tennis court by the seawall, which affects how far back the potential restoration should go.

"Our next step is to decide what our preferred option is," he said. "Once we've made that decision, we need to find dollars to undertake design and construction and part of the design process will include more public input."

Follow progress at [www.seattle.gov/parks/find/parks/lowman-beach-park](http://www.seattle.gov/parks/find/parks/lowman-beach-park). For specific questions about the project, email [david.graves@seattle.gov](mailto:david.graves@seattle.gov) or call him at 206-684-7048.



**The Lowman Beach Park seawall has cracked and shifted to the point that it is allowing erosion.** Photo courtesy Seattle



**FOR YOUTH DEVELOPMENT  
 FOR HEALTHY LIVING  
 FOR SOCIAL RESPONSIBILITY**

**seattleyymca.org**



**Bruce Butterfield**

Realtor & Seniors Real Estate Specialist

[www.BruceButterfield.com](http://www.BruceButterfield.com) 206-932-2400

**A Life-Long  
 Fauntleroy Fan!**

**BERKSHIRE  
 HATHAWAY  
 HomeServices**

# STATE TRYING 'QUICK WINS' TO IMPROVE FERRY LOADING

By Gary Dawson

At its March 27 meeting, the Triangle Improvement Task Force formed by Washington State Ferries (WSF) agreed on a process to improve loading procedures at the Fauntleroy terminal and WSF began implementing those changes in early May. All are to be in place by the end of June.

The task force has three members each from Fauntleroy, Southworth, and Vashon Island, plus representatives of WSF management. Its goal since beginning work in January, is collect, weigh, and recommend strategies to improve performance on the triangle route.

The two "quick wins" recommended in March are to improve vehicle processing during afternoon peak at Fauntleroy tollbooths and to educate drivers about ways they can save time while using the route.

The new procedure places terminal employees at strategic locations to help drivers move more quickly through the tollbooths for ticket processing and scanning. Drivers are issued route-destination cards for quick identification and vehicle staging on the dock. The Seattle Police officer directing off-loading vehicles onto Fauntleroy Way SW now more closely coordinates with the WSF employee directing cars to the tollbooths.

WSF implemented a four-day pilot program starting on May 15 to train employees in the new procedures and familiarize drivers with the changes.

At its next scheduled meeting in early June, the task force will review pilot results and recommend any adjustments. Then WSF will implement final procedures as soon as possible.

These changes will not necessarily reduce the length of the queue on Fauntleroy Way because the number of vehicles waiting to load exceeds ferry capacity during the afternoon commute period. The queue should, however, move faster, such that vessels are more fully loaded at departure time.

As the task force completes its first phase, it will continue to meet monthly to coordinate with and provide input to WSF's long-range planning related to Fauntleroy.

In mid April, WSF notified the task force that, because of heavier ferry traffic earlier in the afternoon, it had asked the Seattle Department of Transportation to increase hours in the no-parking zone southbound on Fauntleroy Way, extending the length of Lincoln Park to the ferry terminal.

Without notifying the community, SDOT replaced "No Parking 3 PM to 7 PM Monday through Friday" signs with ones stating that parked cars will be subject to towing after 2:00 pm. SDOT also did not forewarn the maintenance office at Lincoln Park so it could alert groups and sports teams with reservations about the parking change.

Residents greeted this change with mixed reaction; traffic might flow more smoothly on the arterial but it would force more park users to leave their cars on side streets.



When WSF announced this request, the FCA Board and Fauntleroy Ferry Advisory Committee sent a joint letter to the directors of SDOT and Seattle Parks and Recreation, requesting a public process so that area residents and park users could have input.

To date, SDOT's only response was a mailing to a few residents along Fauntleroy Way after the new signs were installed. As of this writing, the no-parking extension remains in place.

*THE Kenney*  
*West Seattle's Premier Provider of Senior Services*

Ellen Johanson  
Director of Church Relations, Community Outreach,  
and The Kenney Foundation

7125 Fauntleroy Way SW, Seattle, WA 98136-2008  
(206) 937-2800 • Direct (206) 935-8285  
ejohanson@TheKenney.org

**INNATE VITALITY**  
*optimal healing from within*

Pilates  
Strength  
Barre

Nutrition  
Yoga  
Personal Training

**10% Off Any Service\***  
\*new clients only additional restrictions may apply,  
not applicable with any other discounts, mention this  
code to receive discount on registration

4507 SW Wildwood Place, Seattle WA, 98136  
www.innatevitality.com  
206-747-1680

# CLOSE-TO-HOME EVENTS

**MURRAY CSO EVENT:** King County will host a free community celebration on **Saturday, June 10, 10 am - noon**, to mark completion of the Murray CSO "wet weather facility" across from Lowman Beach Park (Lincoln Park Way SW and Beach Drive).

**COMMUNITY BUSINESS:** The FCA Board invites residents to its monthly business meeting on second Tuesdays (**June 13, July 11, Sept. 12**) at **7 pm** in the boardroom at the Fauntleroy Schoolhouse Community Center. Contact FCA President Mike Dey about the agenda at [msdey50@aol.com](mailto:msdey50@aol.com) or 206-661-0673.

**LINCOLN LOVERS:** Show your love of the park's urban forest by joining **Friends of Lincoln Park** for work parties on the **first Saturday** and/or **third Sunday** of the month through the summer. Muster at the kiosk in the north parking lot at **9 am** with sturdy shoes, long pants, work gloves, and water. Contact Sharon Baker at 206-464-1068 or [sabaker41@gmail.com](mailto:sabaker41@gmail.com).

**FOR THE BIRDS:** Bird lovers of all ages and knowledge levels are invited to join Audubon volunteers for the monthly bird survey in Lincoln Park on second Sundays (**June 11, July 9, Aug. 13**), starting at **8 am** at the kiosk in the north parking lot. Details and to enroll at 360-317-4646 or [kerstimuul@rocketmail.com](mailto:kerstimuul@rocketmail.com).

**SPOKEN WORD:** Fauntleroy Church will host an evening of word artistry on **Wednesday, June 28, 7:30 pm** in Fellowship Hall. To inquire about telling a story, sharing your poetry, or doing a reading for "Wine and the Spoken Word," call 206-932-5600, stop by the office, or email [jackie@fauntleroyucc.org](mailto:jackie@fauntleroyucc.org).



**SEATTLE NIGHT OUT:** This year's "Night Out Against Crime" will be **Tuesday, Aug. 1**. Register your block party and request street closure at [www.seattle.gov/police/nightout](http://www.seattle.gov/police/nightout).

## LOW TIDE AT THE BEACH

Volunteer beach naturalists will be on the south beach at Lincoln Park to offer free low-tide explorations as follows:

<b>June 8</b> 10am-noon	<b>July 8</b> 10am-noon
<b>June 9</b> 10am-1pm	<b>July 9</b> 11am-1:30pm
<b>June 10</b> 10:30am-1:30pm	<b>July 21</b> 9am-noon
<b>June 11</b> 11:30am-1:30pm	<b>July 22</b> 9:30am-1pm
<b>June 22</b> 9am-noon	<b>July 23</b> 9:45am-1:45pm
<b>June 23</b> 9:30am-1pm	<b>July 24</b> 10:30am-2pm
<b>June 24</b> 10am-2pm	<b>July 25</b> 11:30am-2:30pm
<b>June 25</b> 10:30am-2:30pm	<b>August 20</b> 9:30am-noon
<b>June 26</b> 11am-3pm	<b>August 21</b> 10am-12:30pm

**2ND TIME SALE:** The 23rd annual **2nd Time Sale** at Fauntleroy Church will be **Saturday, Sept. 16** (9 am - 3 pm), and **Sunday, Sept. 17** (11 am - 1 pm), in and around Fellowship Hall. Watch [www.fauntleroyucc.org](http://www.fauntleroyucc.org) for details and call 206-932-5600 if you have donations.

**RECYCLING:** Fauntleroy Church will host the fall Recycle Roundup on **Sunday, Sept. 24, 9 am - 3 pm** in the church parking lot. Details will be on the *West Seattle Blog* and at [www.fauntleroyucc.org](http://www.fauntleroyucc.org).

## ART SHOW SEEKING LOCAL TALENT

The Fauntleroy Fine Art and Holiday Gift Show is calling for West Seattle and Vashon artists and artistic crafters to apply for the tenth annual event, scheduled the weekend of Nov. 10-12 at Fauntleroy Church.

Artists working in any medium - paint, metal, ceramics, paper, glass, stone, fiber - are welcome to

CALL FOR WEST SEATTLE & VASHON  
**ARTISTS**

apply, as are makers of artistic gifts. Last year, 17 made the cut to show and sell their creations during the three-day event.

For details and the application form, call 206-932-5600 or visit [www.fauntleroyucc.org](http://www.fauntleroyucc.org). Deadline is Sept. 17.



## FOOD FEST 2017

FCA's annual meet-and-greet Fauntleroy Food Fest on **March 21** drew an estimated 175 area residents to the Hall @ Fauntleroy for food, information, and the election of FCA officers and board members. These hungry customers enjoyed samples from the **Wildwood Market**, a first-time participant. Photo courtesy Gail Ann Photography

# FCA CONTINUES ADVOCACY FOR MORE RESTRICTED PARKING

The Seattle Department of Transportation has rejected a request by FCA's parking committee to extend the reach of Restricted Parking Zone #3 to additional blocks in Fauntleroy.

Committee members did two parking surveys last summer and fall, documenting that the situation met SDOT's trigger for an official study: that street parking be at least 75 percent full and that at least 35 percent of those vehicles be non-resident.

According to the letter of denial, data obtained by SDOT did not match that of the committee. Also, the city's threshold requirements appear to be somewhat different now compared to when the committee set to work. FCA has written to ask SDOT to clarify those requirements so the committee can decide about re-collecting data and submitting a new request for zone expansion.

## THE KENNEY *(continued from p. 1)*

considers the best in the state, will be integral to that forward motion.

"With a solid foundation now, we can start looking at expansion and improvement," he said.

The plans previewed last fall remain on the table. They include demolishing duplex rental housing on the south end of the campus to make way for townhouses and apartments. Several units in the existing complex will be enlarged, memory care and nursing/rehab will be updated, and a dining room will be added.

New construction and unit consolidations will enable The Kenney to offer the more spacious accommodations that baby boomers are seeking. The total will be about the same as now: 88 independent apartments, 41 assisting-living units, and 20 private nursing/rehab rooms in a new location.

Memory care is slated to move to the north wing, with six private and two double rooms. A new dining room is to take the space formerly devoted to memory care.

These plans are in the design/permitting phase (including a proposed rezone). And with financing through Heritage Ministries, René is fully expecting to proceed.

Timely communication with residents, families, and the community will be integral to the multi-year undertaking, he said.

"We have every intention to proceed and we intend to do so with purpose and to set a timeline and follow it."



**OCEAN LIGHT ZEN**  
A WELCOMING MEDITATION COMMUNITY

Practice 9 am - 11 am Sundays  
Details or to arrange first-time instruction:  
[oceanlightzen@gmail.com](mailto:oceanlightzen@gmail.com)

Room 4, Fauntleroy Schoolhouse  
9131 California Ave. SW, Seattle 98136



## STUDENTS HEAR FROM STUDENTS

The early May salmon release by Genesee Hill Elementary fourth graders included a chat with EarthCorps trainees restoring the Kilbourne ravine. Crewmembers from seven states and one foreign country talked about the project and their plans after they complete the Seattle-based program. Watershed volunteers hosted 19 field trips for nearly 750 students to release coho into Fauntleroy Creek through the Salmon in the Schools program. Photo courtesy Judy Pickens

## NEW PAINT AT TRIANGLE?

In response to continued complaints about a noxious odor, FCA is pushing the Seattle Department of Transportation to replace the red paint used last summer to mark pavement in Fauntleroy's triangle business area. The request is to cover or remove it in favor of the city's standard grey pavement and yellow curbing.

The FCA Board also asked that confusing painting to mark the loading zone along the one-way street be rectified and that the loading-zone sign be lowered to be easier to see.



dsquaredcompany.com      206.932.1059

**Worshiping and learning together, caring for ourselves and others, and working to preserve justice, peace, and the sanctity of God's world.**



**10 AM Sunday worship**  
206-932-5600  
[www.fauntleroyucc.org](http://www.fauntleroyucc.org)  
9140 California Ave. SW

# INDUSTRY STRATEGY MIGHT IMPROVE GOVERNMENT RESPONSE TIME

By FCA President Mike Dey

One of the fun things about being FCA president is the wealth of opportunities I've had to work with governmental agencies and departments. They have included the mayor's office, City Council, Seattle Police Department, Seattle Department of Transportation, Seattle Office of Planning and Community Development, County Council, King County Metro, King County Department of Natural Resources and its wastewater division, and Washington State Ferries.



When I talk with neighbors about this aspect of the job, I get responses best summarized by "impossible to work with" and "incredibly slow." I can't remember anyone saying "Oh, the staff people there were great!"

My career was in pharmaceuticals, a heavily regulated industry where everything we did required governmental review and approval. I soon became accustomed to operating within tightly controlled processes.

What I learned then is applicable to what I've experienced with local government: that most employees are trying to do a good job. For sure, some choose to use regulations to exert control beyond what is intended but they are the exception. Once a relationship is established, most of the public servants with whom I've interacted have been willing to work with us.

The issue of speed or lack thereof *is* frustrating. It can

be the same here as I found with the federal government.

An ongoing example is the pedestrian crossing light FCA requested the city install at Fauntleroy Way and Rose. Metro put RapidRide stops there, apparently with no consideration for how riders would safely cross the arterial during rush hour. The city has made no progress on safety in two-plus years, initially citing the cost of curb cuts. Turns out curb cuts were already there. The best we've been able to do is put out pedestrian crossing flags.

Viewed from the outside, every action or decision appears to need to creep all the way to the top for approval, then crawl back down for implementation. Lack of delegation can be to blame but the general explanation I became accustomed to hearing was that departments were woefully under funded and thus under staffed.

One way we dealt with this situation in industry was for affiliated companies to contribute funds toward extra staffing to speed turnaround. A performance contract required the setting of review milestones and deadlines. The impact was pretty remarkable.

While this strategy may be a bit premature for Seattle's neighborhoods, I believe a discussion about how priorities are arrived at and the length of time required to get things done would begin to improve the interaction we have with city departments and employees. After all, we should be about the same thing: protecting and improving the quality of life here in Fauntleroy and throughout the city.

KEEP UP TO DATE ON FAUNTLEROY EVENTS ON FACEBOOK  
If you're a member of Facebook, go to [www.facebook.com/FauntleroyCommunityAssociation](http://www.facebook.com/FauntleroyCommunityAssociation).

[WWW.FAUNTLEROY.NET](http://WWW.FAUNTLEROY.NET)

P.O. BOX 46343  
SEATTLE, WA 98146

